



**Swadiansa, Eka
(Indonesia)**

OSA, SU-CSC
principal@studio-osa.com

Eka Swadiansa is the chief bureau and principal of Office of Strategic Architecture (OSA), research director of Surya University Center for Static City (SU-CSC), lead curator of SPIRIT_45, and Global University (GU) founding member; recipient of 2009 Tadao Ando Foundation/OFIX, and Terrefarm/SOM fellowship.

Upon graduating from Brawijaya University and working/interned on various companies which includes Japan giant: Takenaka Corporation; he established OSA to strive for 3 different focuses: (1) *Iconoloci*/architecture as cultural reinterpretation medium, (2) *Static City*/planning for the South-South alpha/beta cities, and (3) *Reactive Capitalism*/banking mechanism which fuels capital accumulation over social-based business cycle.

Throughout the years he had been invited to present his works on prestigious institutions such as: the MIT, ENSA Paris LV, ENSA Rouen; and exhibited his works on venues around the globe including: INBAR Industry@Shanghai World Expo, Central Glass@Tokyo UIA Congress, Guggenheim Helsinki Exhibition, Le Galerie Librarie du Impressions, and Strelka Institute Mass Housing Exhibition.

TOPIC 1 : AMPENAN CREATIVE HUB
And Its Multilayer Context Reading

TOPIC 2 : AMPENAN CITY WALK
And Its Multipresedent Form Making

TOPIC 3 : AMPENAN WATERFRONT PARK
And Its Multiyear Financial Engineering

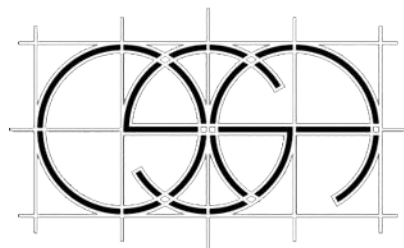

And Its Multilayer Context Reading

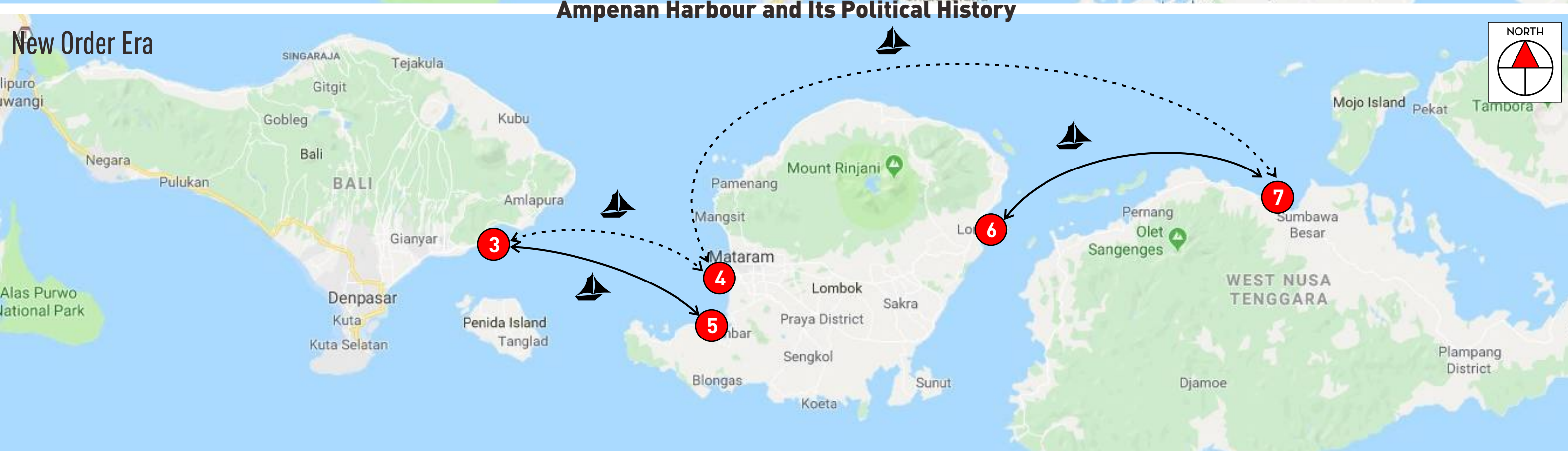
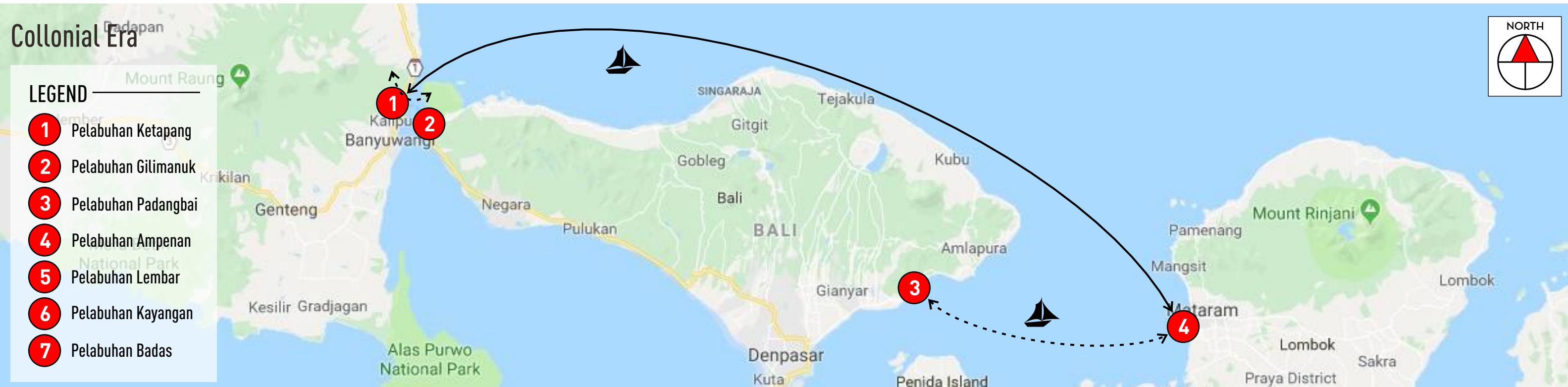

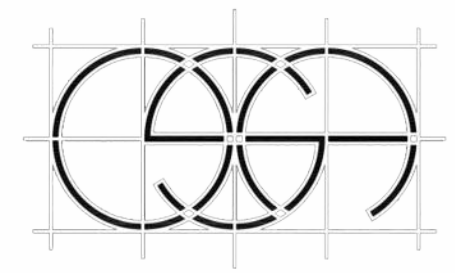

LEGEND

- Cluster 1
- Cluster 2
- Cluster 3
- Site

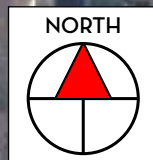
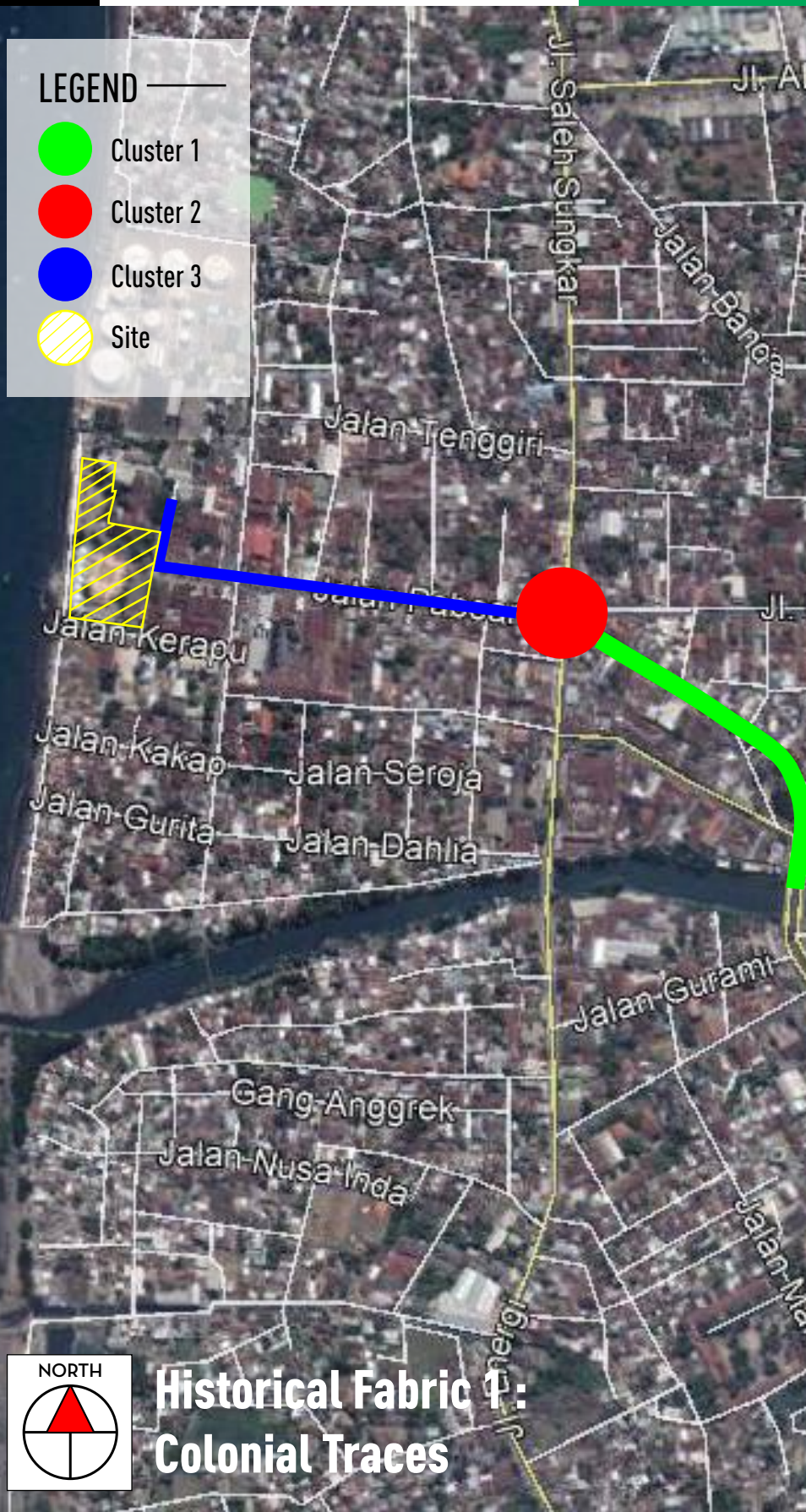

**Historical Fabric 1:
Colonial Traces**

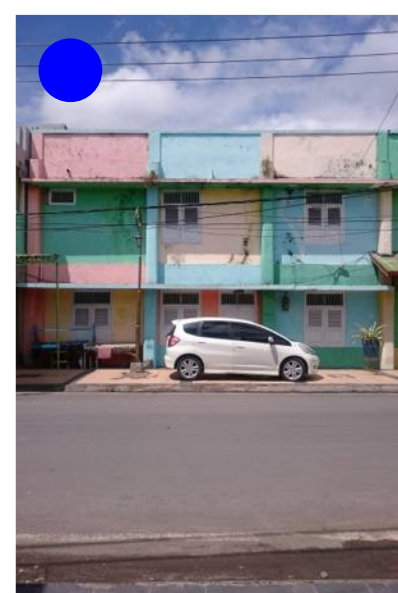
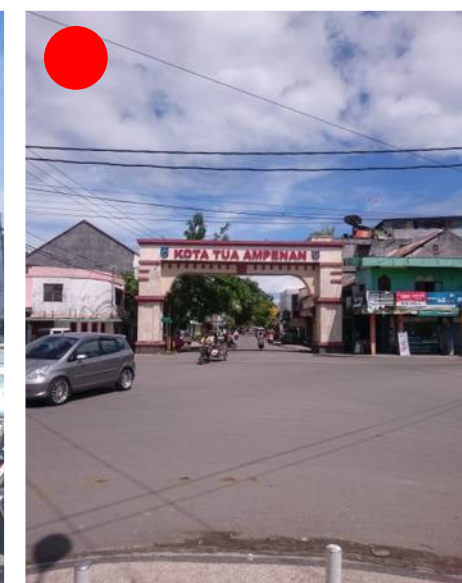
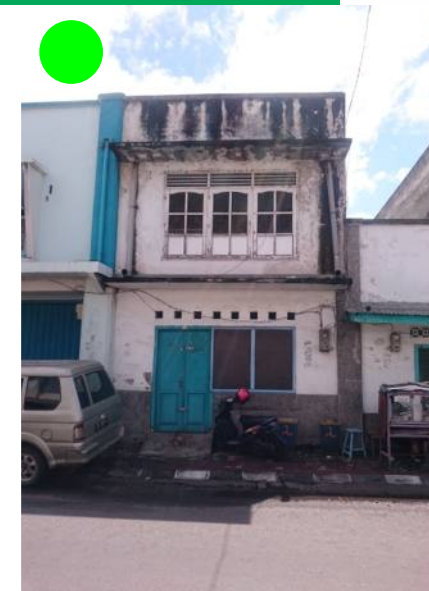
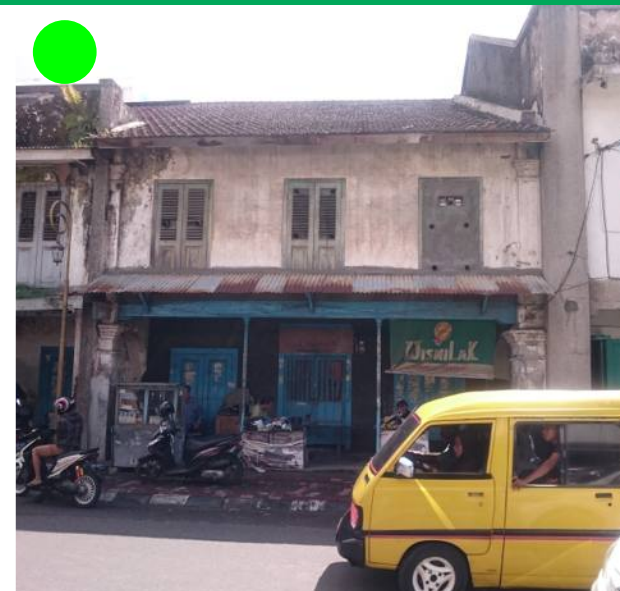



AMPENAN CREATIVE HUB

OFFICE OF STRATEGIC ARCHITECTURE

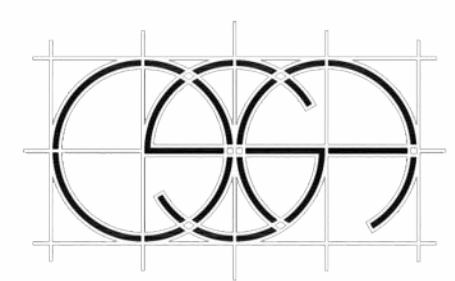

Site Contexts :
No Found Contexts





AMPENAN CREATIVE HUB

OFFICE OF STRATEGIC ARCHITECTURE

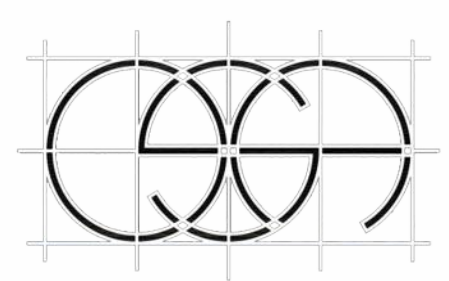

BEFORE

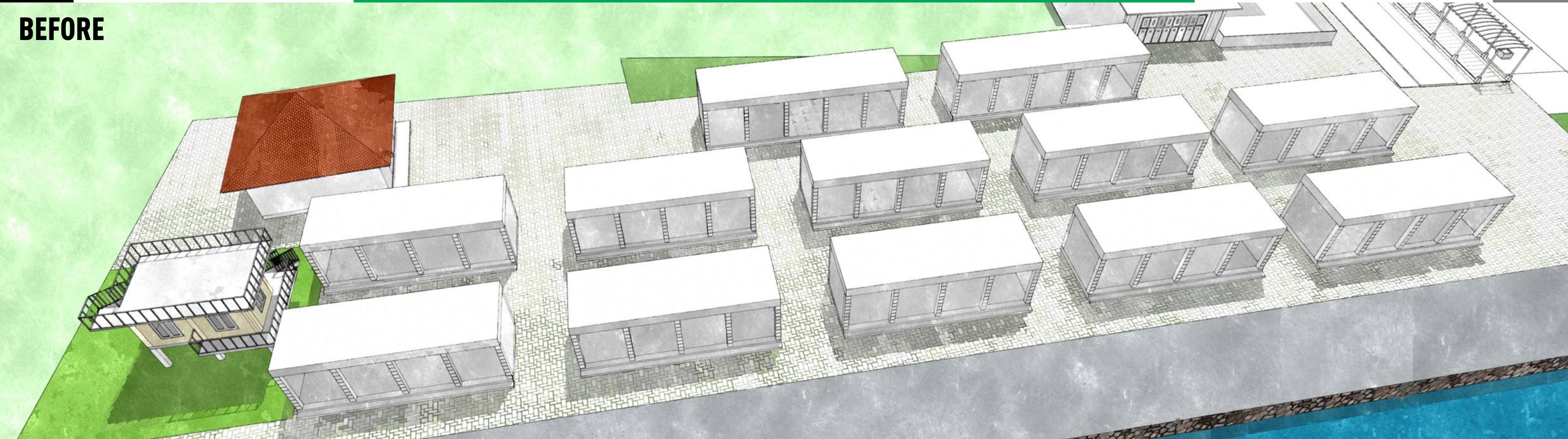

AFTER



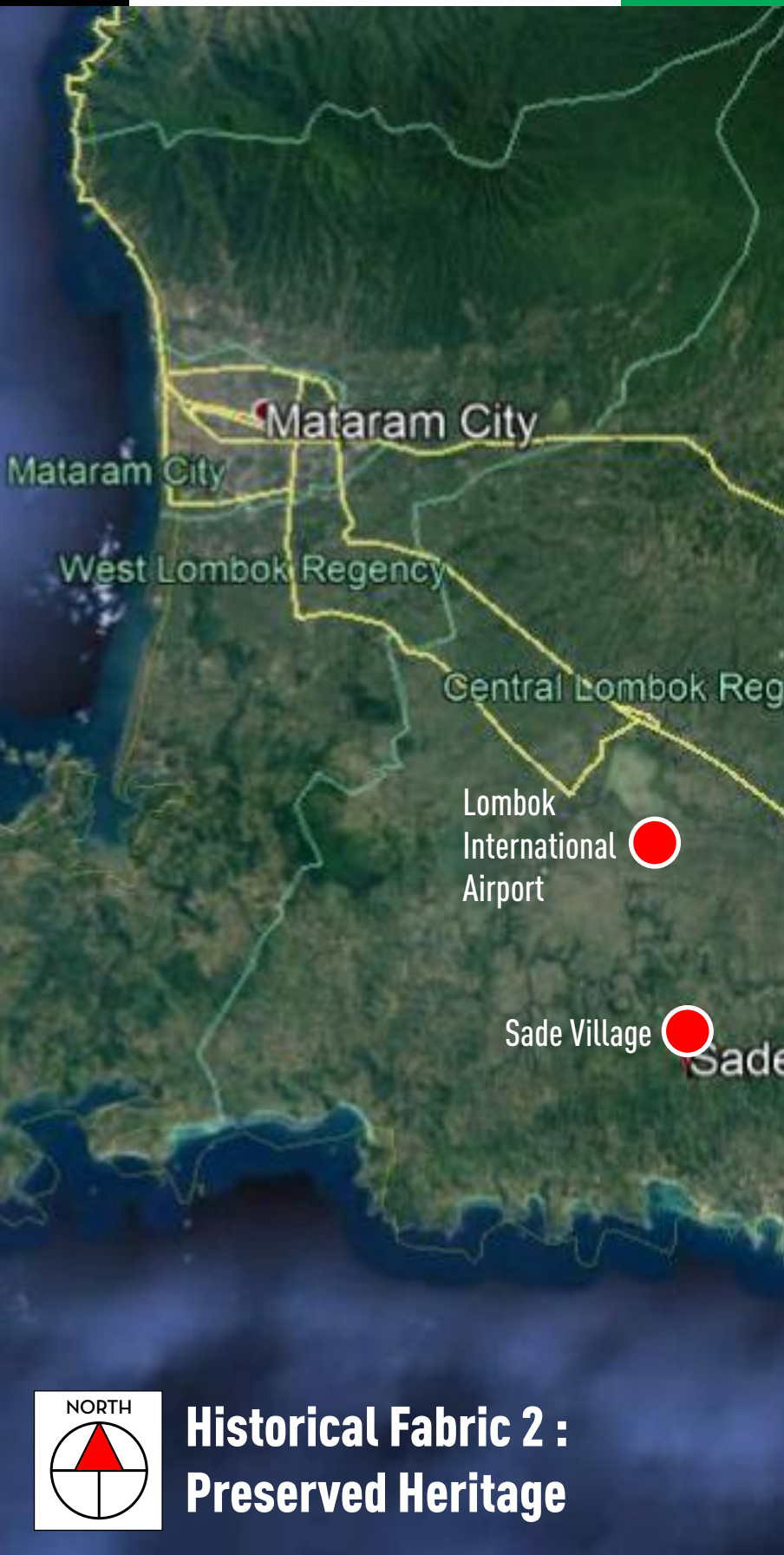
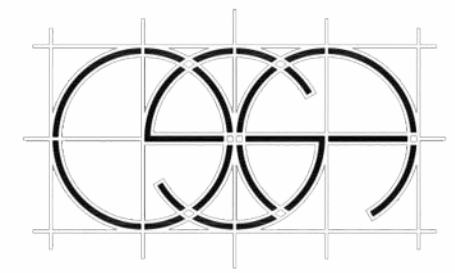

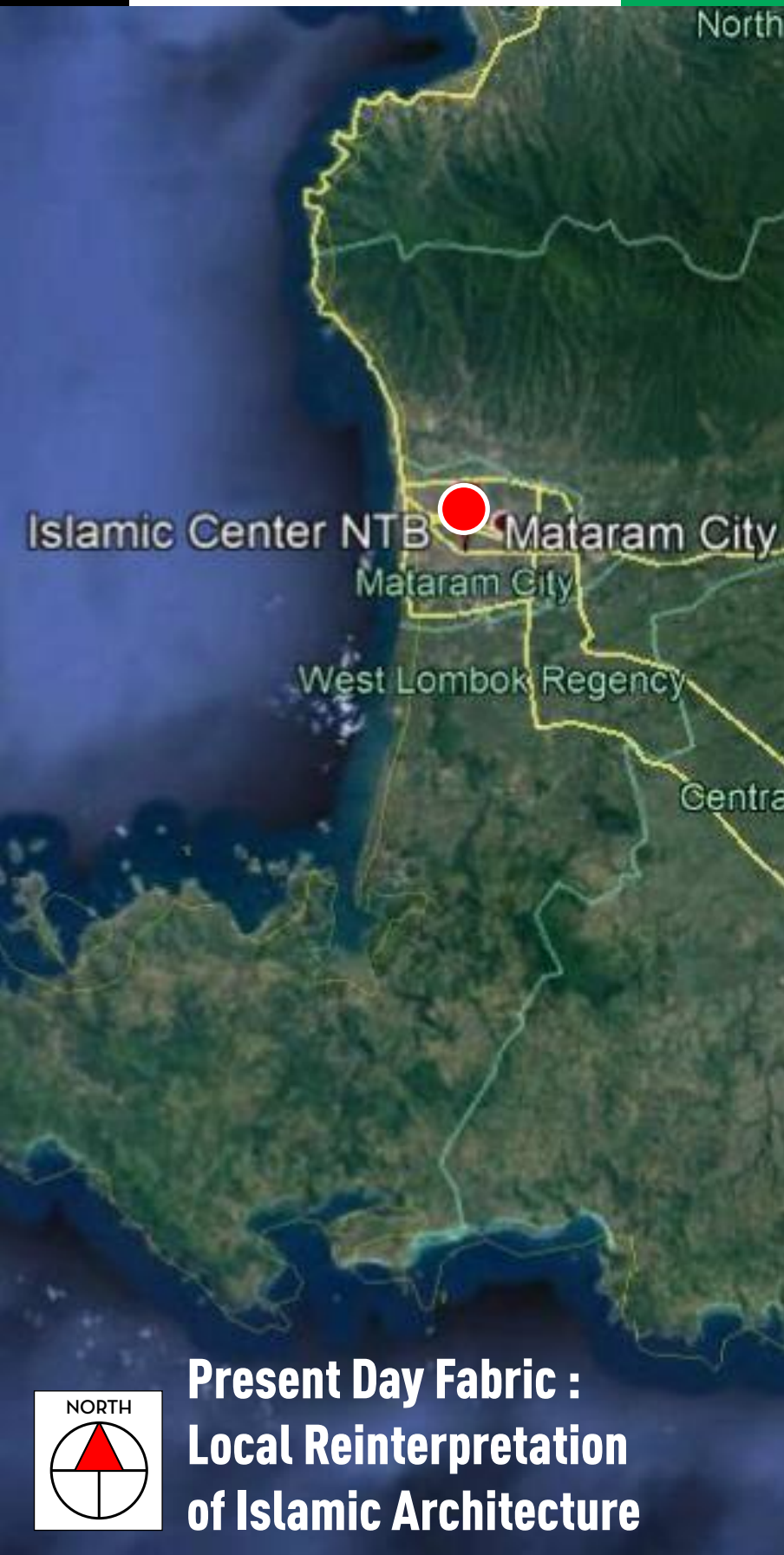
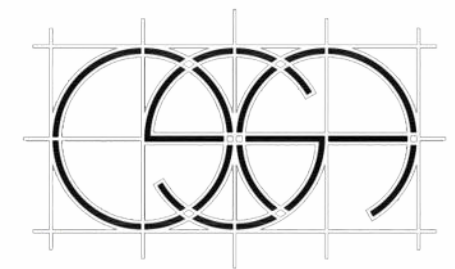

Present Day Fabric :
Local Reinterpretation
of Islamic Architecture

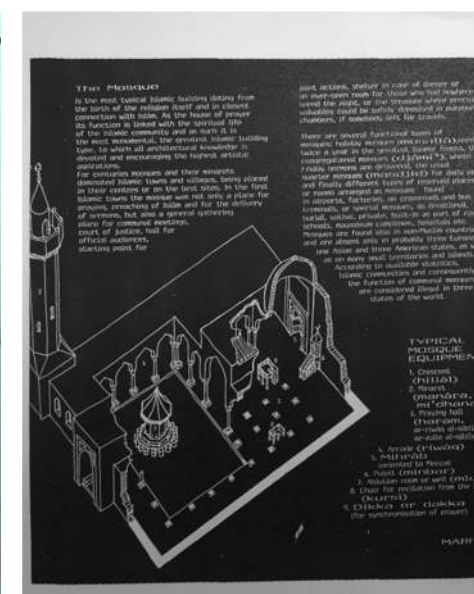
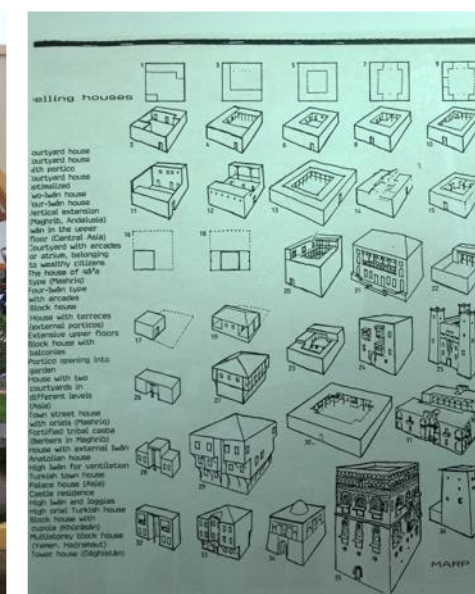
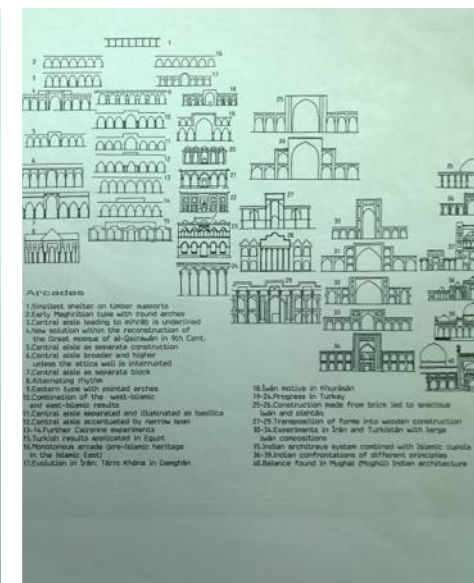
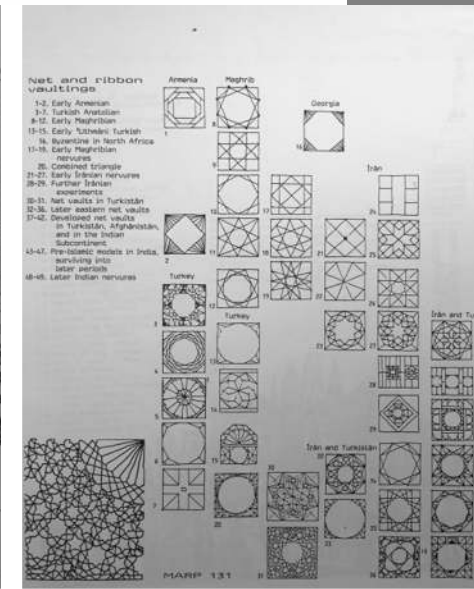
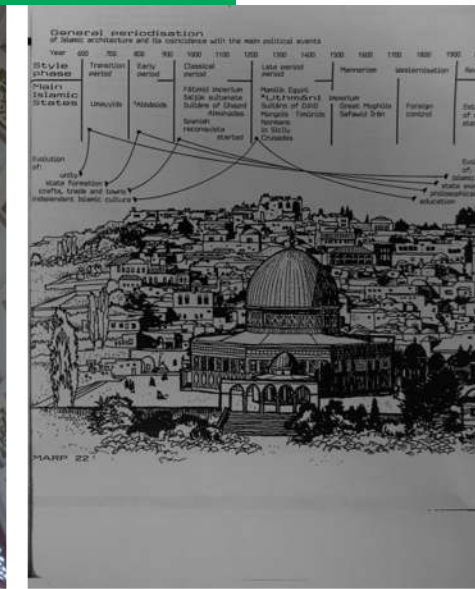
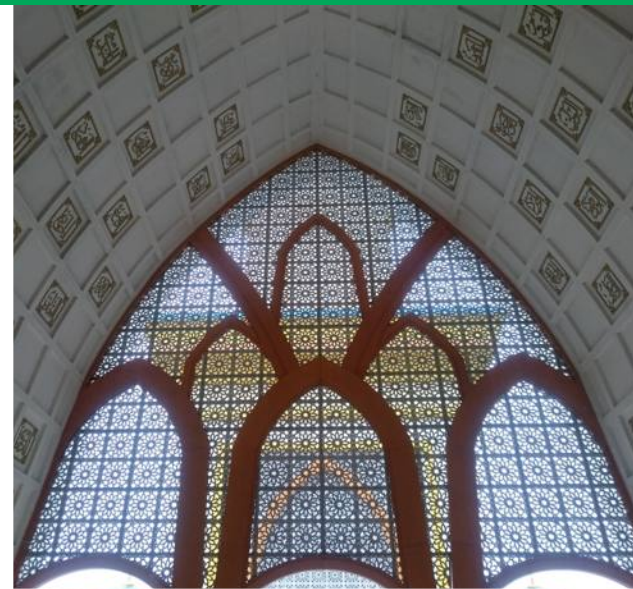
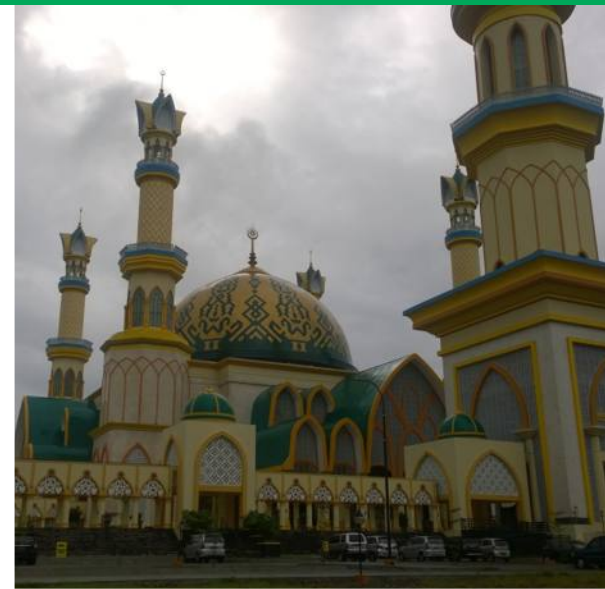
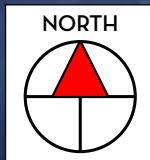



AMPENAN CITY WALK

OFFICE OF STRATEGIC ARCHITECTURE

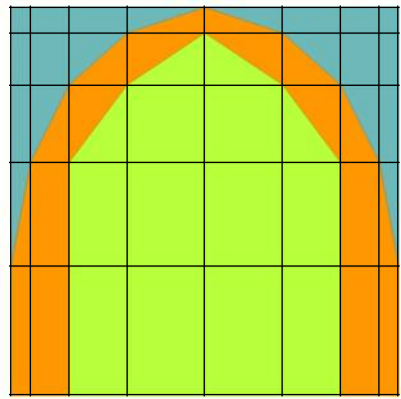
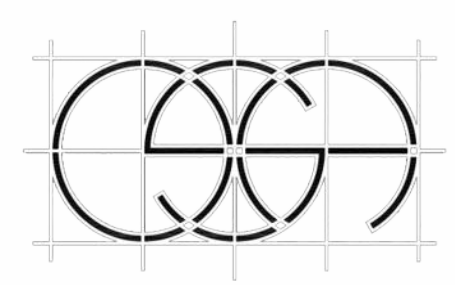

// + 1

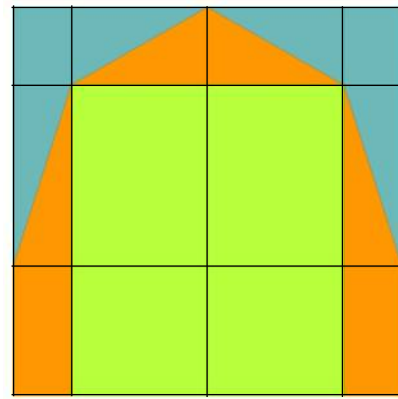

$\theta = 15^\circ$

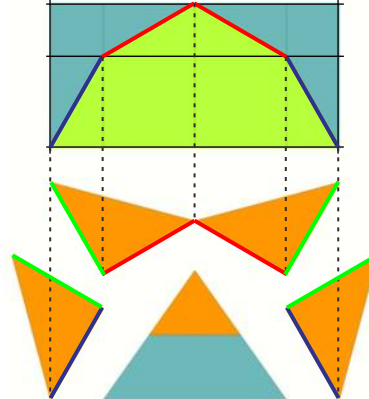

$y = x$

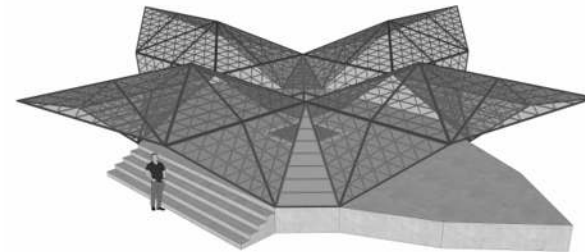
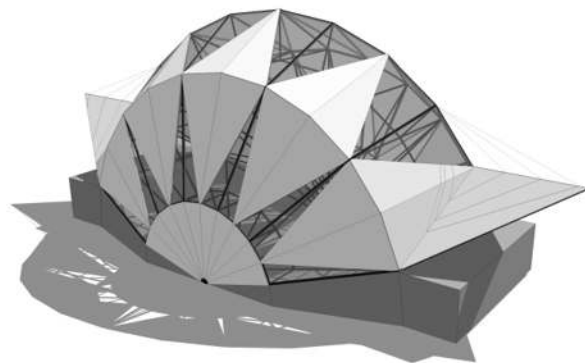
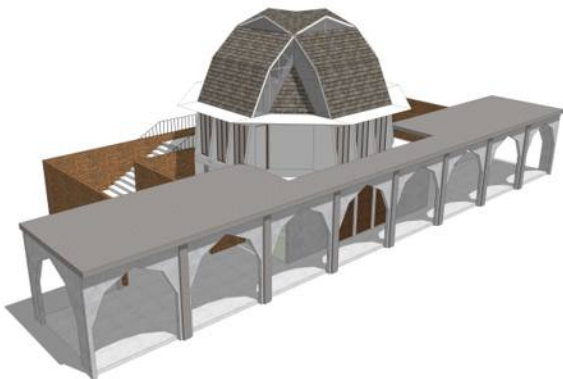
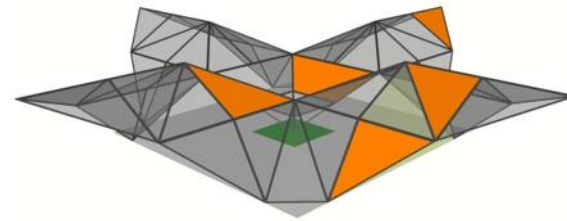
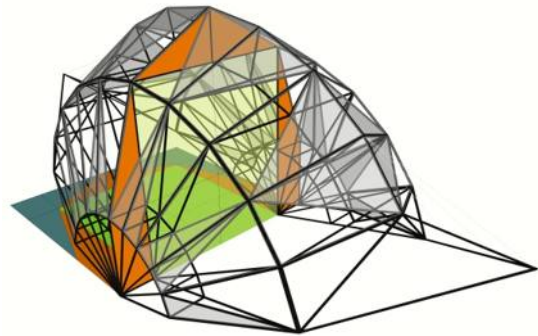
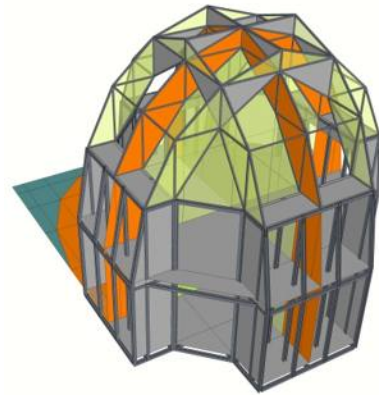
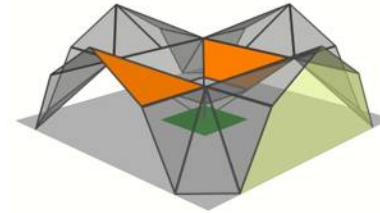
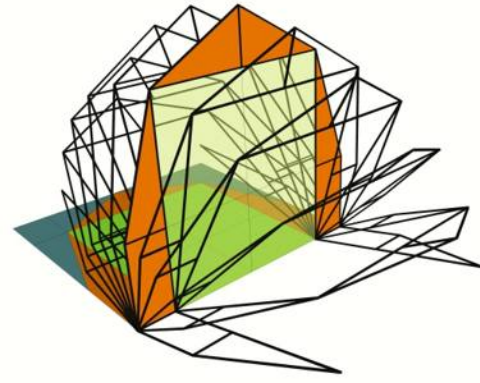
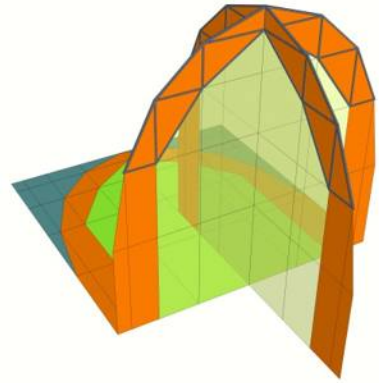



AMPENAN CITY WALK

OFFICE OF STRATEGIC ARCHITECTURE

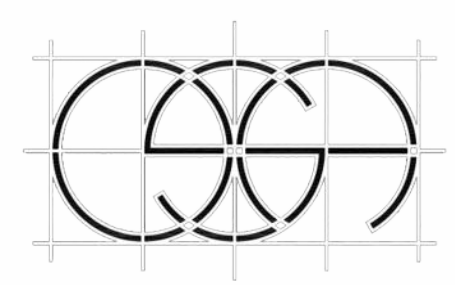



AMPENAN WATERFRONT PARK

OFFICE OF STRATEGIC ARCHITECTURE

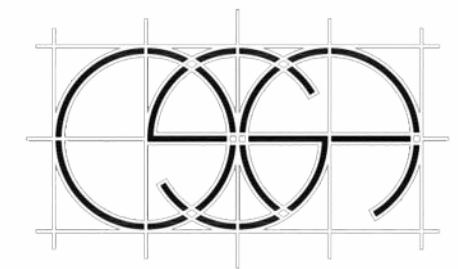

Waterfront Park Project Index

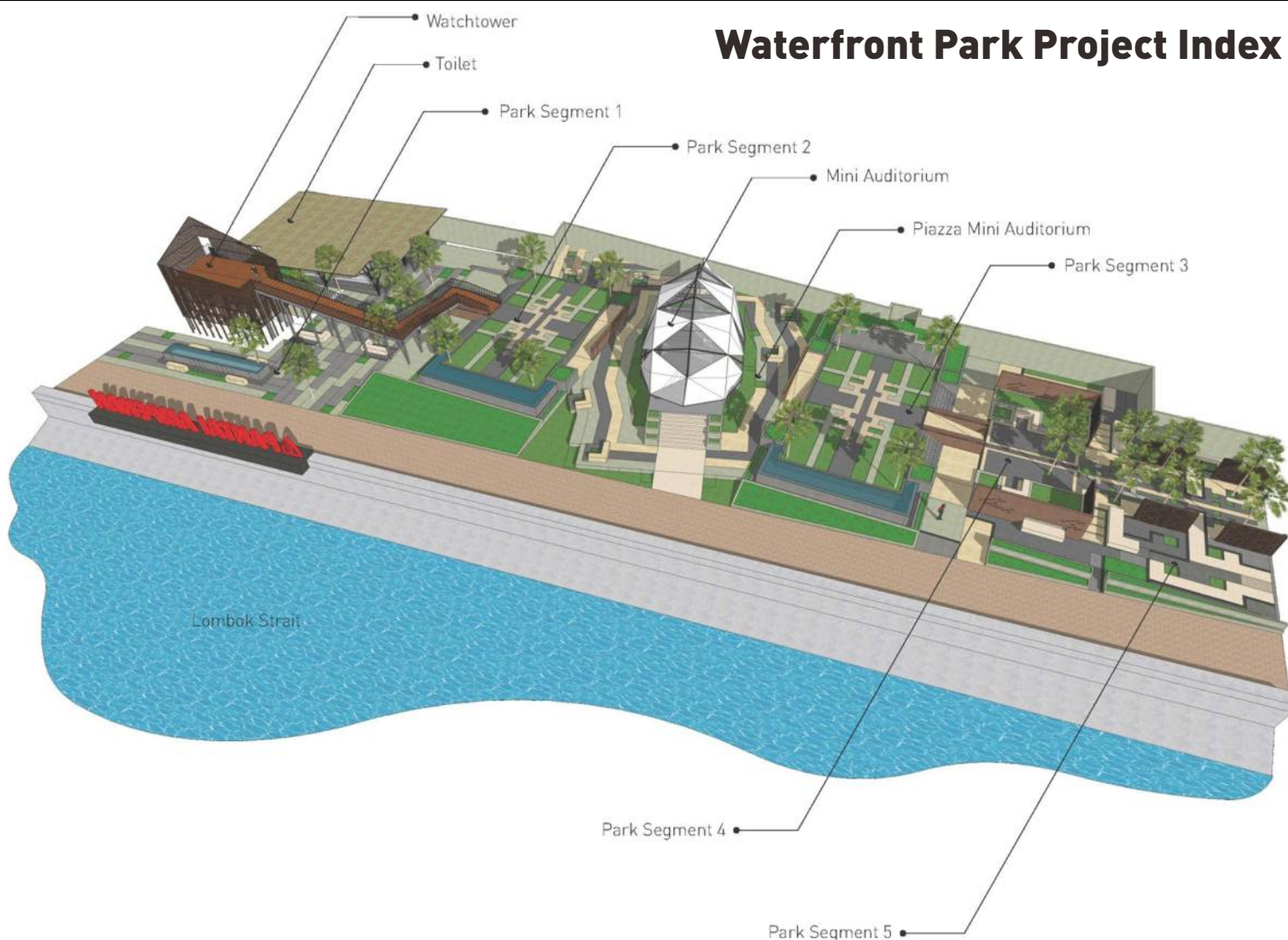

Selfie Tower



Public Toilet

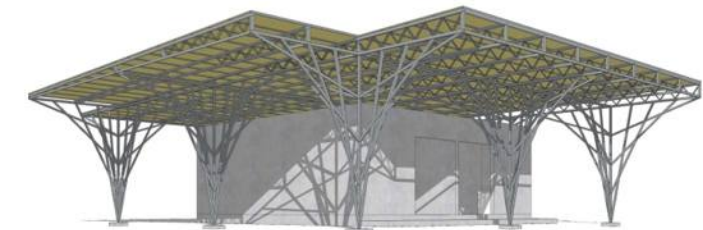

Amphi. Roofing

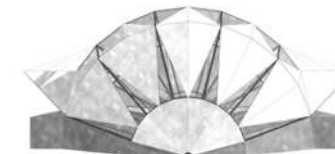

Amphi. Podium

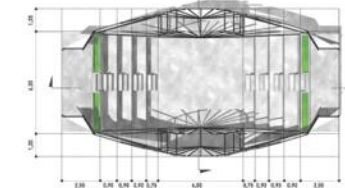

Amphi. Piazza



Park Segment 1



Park Segment 2



Park Segment 3



Park Segment 4

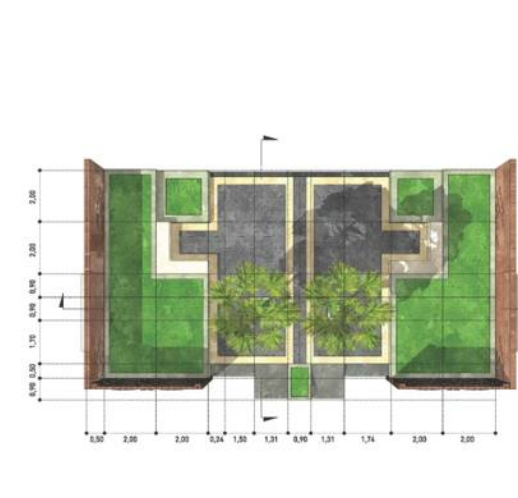

Park Segment 5





AMPENAN WATERFRONT PARK

OFFICE OF STRATEGIC ARCHITECTURE

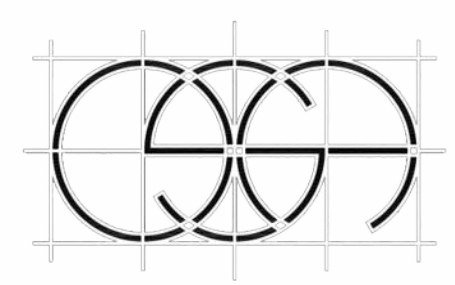

Citywalk Project Index

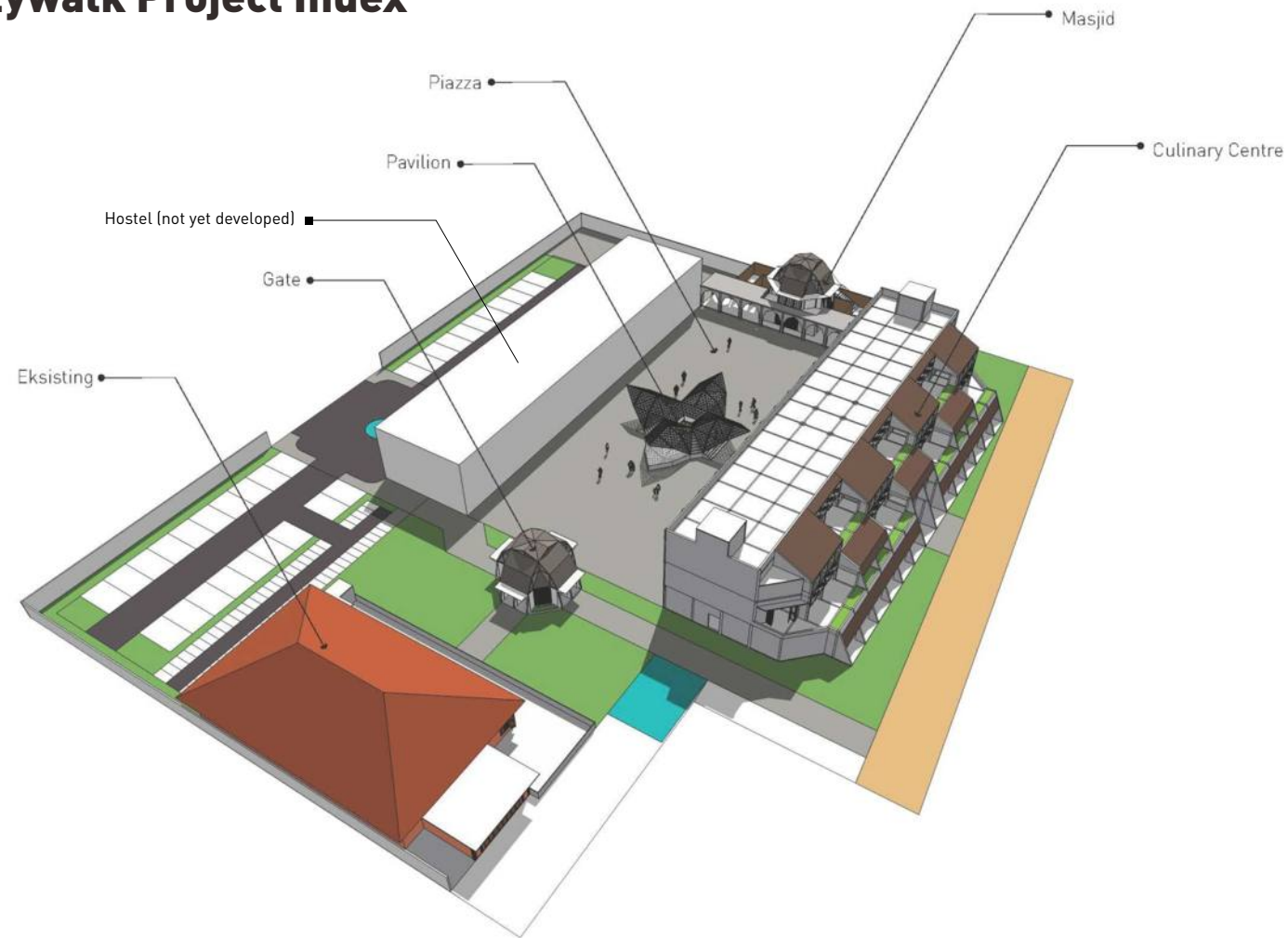

Culinary Center 1F

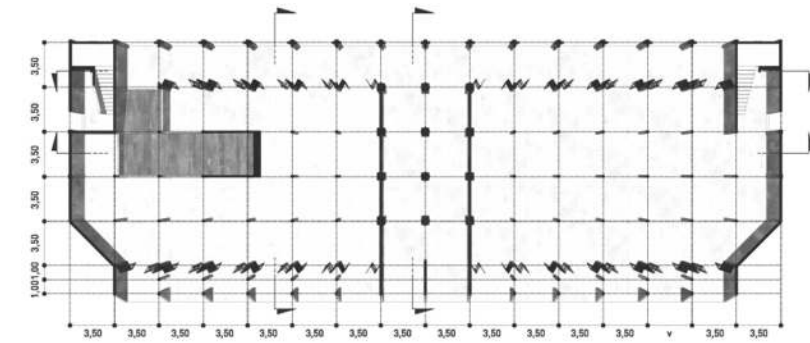

Culinary Center 2F

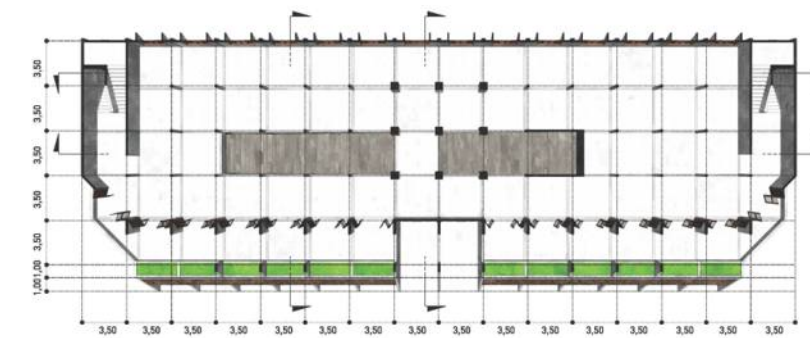

Culinary Center 3F

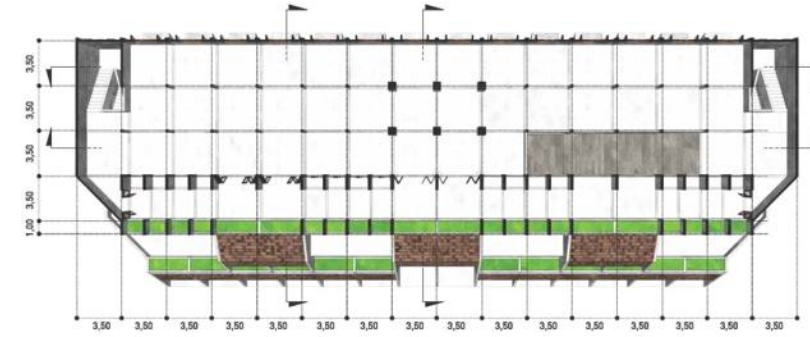

Piazza



Mosque



Temp. Culiner Ctr.



Pavilion

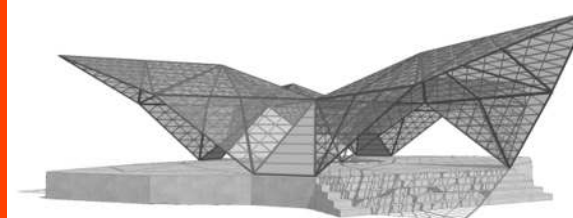

Gate



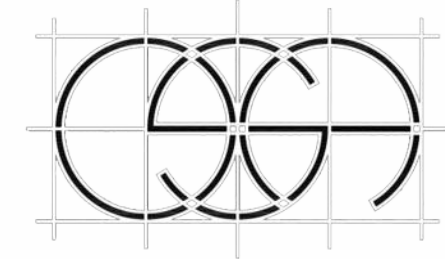

PRIVATE SECTOR



AMPENAN WATERFRONT PARK

OFFICE OF STRATEGIC ARCHITECTURE

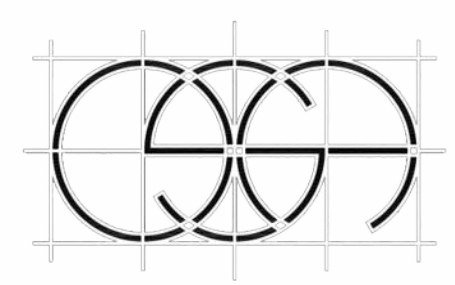

Project Progress Report

